

RACCORDI E VALVOLE

Inox alimentare (a mandrinare DIN 11851-52)

Esecuzione: costruzione in inox 304 o 316

Diametri: DN 25 ÷ DN 100

Pressioni d'esercizio: 10 bar

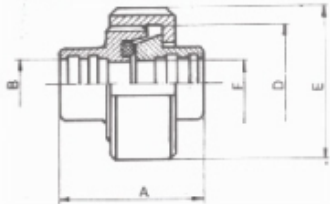
Raccordo completo 		Dimensioni					
DN	A	B	C	D	E	F	
25	44	28	-	52x1/6"	63	26.5	
32	50	34	-	58x1/6"	70	32.5	
40	53	40	-	65x1/6"	78	38.5	
50	57	52	-	78x1/6"	92	50.5	
65	65	70	-	95x1/6"	112	66.5	
80	74	80-85	-	110x1/4"	127	-	
90	71	87-93	-	120x1/4"	138	-	
100	89	100-106	-	170x1/4"	148	-	

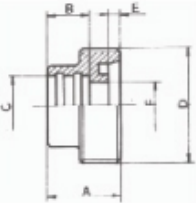
Bocchettone femmina filettato 		Dimensioni					
DN	A	B	C	D	E	F	
25	29	15	28.2	52x1/6"	7	26.5	
32	32	18	34.2	58x1/6"	7	32.5	
40	33	20	40.2	65x1/6"	7	38.5	
50	35	22	52.2	78x1/6"	7	50.5	
65	40	25	70.3	95x1/6"	8	66.5	
80	44	28	a ric.	110x1/4"	8	a ric.	
90	44	28	a ric.	120x1/4"	10	a ric.	
100	53	35	a ric.	130x1/4"	10	a ric.	

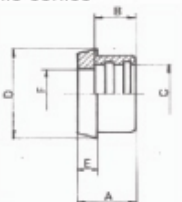
Bocchettone maschio conico 		Dimensioni					
DN	A	B	C	D	E	F	
25	22	15	28.2	44	10	26.5	
32	25	18	34.2	50	10	32.5	
40	26	20	40.2	56	10	38.5	
50	28	22	52.2	68	11	50.5	
65	32	25	70.3	86	12	66.5	
80	35	28	a ric.	100	12	a ric.	
90	35	28	a ric.	111	15	a ric.	
100	42	35	a ric.	121	15	a ric.	

FORINA S.r.l.

Via Polveriera, 42

80141 – NAPOLI

P.IVA 04448850638

Tel. +39 081 7516077 pbx

Fax +39 081 7805490

www.forina.it



RACCORDI E VALVOLE

Inox alimentare (a mandrinare DIN 11851-52)

Girella

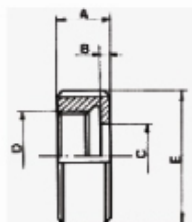

Dimensioni

DN	A	B	C	D	E	F
25	21	3	36	52x1/6"	63	
32	21	3	42	58x1/6"	70	
40	21	3	49	65x1/6"	78	
50	22	3	62	78x1/6"	92	
65	25	4	80	95x1/6"	112	
80	30	4	94	110x1/4"	127	
90	30	4	104	120x1/4"	138	
100	31	5	115	130x1/4"	148	

Guarnizione
in gomma

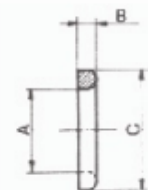

Dimensioni

DN	A	B	C	D	E	F
25	30	5	40			
32	36	5	46			
40	42	5	52			
50	54	5	64			
65	71	5	81			
80	85	5	95			
90	94	5	104			
100	104	5	114			

Bocchettone femmina
filettato con attacco
filettato GAS



Dimensioni

DN	A	B	C	D	E
25	48	26	1"	52x1/6"	18
32	52	32	1 1/4"	58x1/6"	18
40	57	38	1 1/2"	65x1/6"	25
50	62	50	2"	78x1/6"	25
65	68	66	2 1/2"	95x1/4"	25
80	73	78	3"	110x1/4"	25
90	73	85	3 1/2"	120x1/4"	25
100	83	98	4"	130x1/4"	30

Bocchettone femmina
con interno filettato
GAS

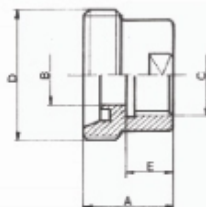

Dimensioni

DN	A	B	C	D	E
25	30	26	1"	52x1/6"	18
32	35	32	1 1/4"	58x1/6"	22
40	35	38	1 1/2"	65x1/6"	22
50	35	50	2"	78x1/6"	22
65	40	66	2 1/2"	95x1/4"	25
80	50	78	3"	110x1/4"	27
90	53	85	3 1/2"	120x1/4"	27
100	60	98	4"	130x1/4"	30

FORINA S.r.l.

Via Polveriera, 42

80141 – NAPOLI

P.IVA 04448850638

Tel. +39 081 7516077 pbx

Fax +39 081 7805490

www.forina.it



RACCORDI E VALVOLE

Inox alimentare (a mandrinare DIN 11851-52)

inox alimentare (a mandamare DIN 11851)

Valvola a sfera tre vie
con attacchi femmina
serie DIN 11851
a passaggio totale

Dimensioni

DN	A	B	C	D
25	135	185	75	25
32	135	185	75	30
40	144	195	80	38.5
50	172	240	90	49
65	204	255	120	65
80	232	320	140	75
100	276	320	160	98

Valvola a farfalla
con attacchi DIN
femmina-femmina

Dimensioni

DN	A	B	C	D
25	66	65	170	7
32	66	68	170	7
40	66	72	170	7
50	70	82	170	7
65	78	89	170	8
80	88	96	170	8
90	88	101	170	10
100	90	106	170	10

Indicatore di passaggio
con attacchi DIN
femmina-femmina

Dimensioni

DN	A	B
25	148	52x1/6"
32	163	58x1/6"
40	175	65x1/6"
50	178	78x1/6"
65	217	95x1/6"
80	232	110x1/4"
90	242	120x1/4"
100	270	130x1/4"

Valvola pneumatica
ON-OFF a due vie

Valvola pneumatica
ON-OFF a tre vie

Esecuzione: parti a contatto in AISI 316L - altri componenti AISI 304L - lucidatura a specchio - guarnizioni a contatto col prodotto di tipo alimentare e certificate - altre guarnizioni in NBR - attacchi a saldare DIN, SMS, IDF, BS e Tri-Clamp da DN 10 a DN 125. Pressione massima 10 bar Pressione minima vuoto Temperatura da -10°C a +140°C - comando aria da 6 a 8 bar Applicazione a semplice o doppio effetto.

Impieghi: industria alimentare, farmaceutica e chimica.

FORINA S.r.l.

Via Polveriera, 42

80141 - NAPOLI

P.IVA 04448850638

Tel. +39 081 7516077 pbx

Fax +39 081 7805490

www.forina.it



RACCORDI E VALVOLE

Inox alimentare (a mandrinare DIN 11851-52)

Curva a 90° completa
di raccordi

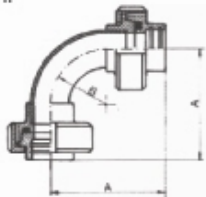

Dimensioni

DN	A	B
25	99	50
32	110	56
40	117	63
50	131	72
65	149	85

Curva 90°

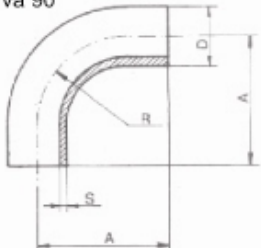

Dimensioni

DN	D	S	A	B	R	E
25	28	1.25	70	73	43	24
32	34	1.25	80	83	52	27
40	40	1.25	90	89	60	27
50	52	1.25	100	103	72	30
65	70	2	110	108	85	30
80	85	2	130	120	93	30
100	101.6	2	150	150	110	35

Curva 180°

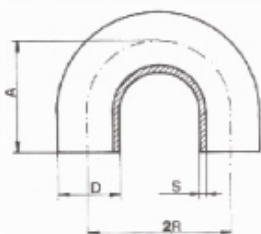

Dimensioni

DN	D	S	A	B	R	E
25	28	1.25	70	73	43	24
32	34	1.25	80	83	52	27
40	40	1.25	90	89	60	27
50	52	1.25	100	103	72	30
65	70	2	110	108	85	30
80	85	2	130	120	93	30
100	101.6	2	150	150	110	35

Curva 45°

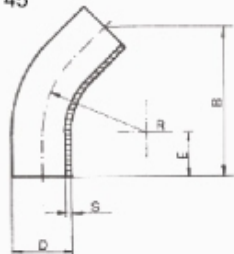

Dimensioni

DN	D	S	A	B	R	E
25	28	1.25	70	73	43	24
32	34	1.25	80	83	52	27
40	40	1.25	90	89	60	27
50	52	1.25	100	103	72	30
65	70	2	110	108	85	30
80	85	2	130	120	93	30
100	101.6	2	150	150	110	35

FORINA S.r.l.

Via Polveriera, 42

80141 – NAPOLI

P.IVA 04448850638

Tel. +39 081 7516077 pbx

Fax +39 081 7805490

www.forina.it



RACCORDI E VALVOLE

Inox alimentare (a mandrinare DIN 11851-52)

Te

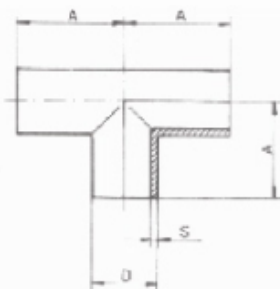

Dimensioni

DN	D	S	A
25	28	1.5	50
32	34	1.5	56
40	40	1.5	67
50	52	1.5	72
65	70	2.00	85
80	80-83	2.00	120
90	88.9	2.00	120
100	101.6	2.00	120

Riduzione

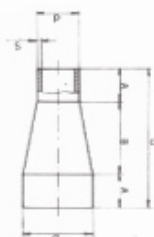

Dimensioni

D/d	S	A	B	C
34-28	1.5	40	18	98
40-28	1.5	40	36	116
40-34	1.5	40	18	98
52-34	1.5	40	53	133
52-40	1.5	40	35	115
70-52	1.5	45	47	137

Chiave universale
per girelle

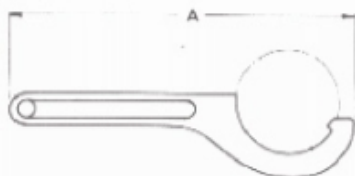

Dimensioni

DN	A	B	C
25	250		
32	250		
40	250		
50	250		
65	250		
80	250		
90	250		
100	250		

Valvola a sfera due vie
con attacchi a manicotto
e passaggio totale Gas
UNI 338

A richiesta
Attacchi DIN
e CLAMP

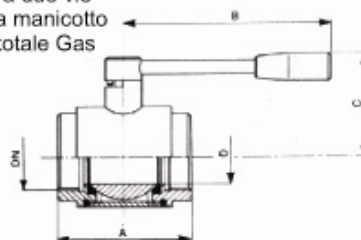

Dimensioni

DN	A	B	C	D
1/4"-3/8"	52	62	45	9
1/2"	59	103	70	13
3/4"	75	103	76	19
1"	82	127	100	24
1 1/4"	98	127	110	32
1 1/2"	104	150	110	40
2"	125	180	125	50
2 1/2"	142	180	125	65
3"	152	275	134	80
4"	189	275	155	100

FORINA S.r.l.

Via Polveriera, 42

80141 - NAPOLI

P.IVA 04448850638

Tel. +39 081 7516077 pbx

Fax +39 081 7805490

www.forina.it